



Last unit available. A new front line residential development in the harbour of Mahón, Menorca

Ref.: 91860

The final unit of this exclusive development is now available in the enchanting area of Cala Corb — a small cove in the heart of Es Castell that opens like a window onto the waterfront of Mahón harbour, offering privileged views. Its location, close to all local amenities, makes it an ideal option both for year-round living and for enjoying unforgettable holidays in Menorca. This last available property is a two-bedroom, two-bathroom apartment that perfectly blends modern, high-quality construction with the historic charm and culture of its surroundings. The development features a unique communal area crowned by a rooftop swimming pool offering an impressive skyline — the perfect spot to unwind with a swim or simply watch the boats glide by. The price includes a private parking space, a true added value in this sought-after location. In terms of construction, great care has been taken to use materials that reflect the island's essence —



Price: 349.000 €

	Cons.	Emiss.
A		
B		
C		
D		
E		
F		
G		

The information shown is provided by third parties for information only and are assumed correct.
The data are subject to errors, price changes and withdrawal without notice.



The information shown is provided by third parties for information only and are assumed correct.
The data are subject to errors, price changes and withdrawal without notice.



The information shown is provided by third parties for information only and are assumed correct.
The data are subject to errors, price changes and withdrawal without notice.



The information shown is provided by third parties for information only and are assumed correct.
The data are subject to errors, price changes and withdrawal without notice.



PRÓXIMO A PROPIEDAD

The information shown is provided by third parties for information only and are assumed correct.
The data are subject to errors, price changes and withdrawal without notice.



The information shown is provided by third parties for information only and are assumed correct.
The data are subject to errors, price changes and withdrawal without notice.

APROXIMADAS
LA PROPIEDAD



cala corb
NEW PROJECT

TOTA HABITATGE 4 (P. 11)
SUP. CONSTRUÏDA PLANTA 80.80 m²
SUP. CONSTRUÏDA DUPLEX 0 m²
SUP. CONSTRUÏDA INTERIOR 80.80 m²
SUP. EXTERIOR 8.24 m²

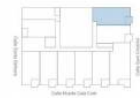

Plànol d'informació, susceptible de ser modificat per necessitats tècniques, perfilatge, comercial o normativa, les superfícies aproximades són orientatives. Caldrà sempre verificar les modificacions per ordre d'obra i verificar les dades en el desenvolupament de l'obra.
L'informació és basada en dades proporcionades pels propietaris i no garanteix la veritat.



PROVALIXHOMES

The information shown is provided by third parties for information only and are assumed correct.
The data are subject to errors, price changes and withdrawal without notice.